

# PENTECOST

## CALL TOGETHER IN ONE PLACE

17-19  
MAY  
2024

## Welcome to Baptist Assembly 2024

It is wonderful to welcome you!  
We are so pleased that you are part of our Assembly this year.

Please see details of each of the sessions and a layout of the Telford International Centre overleaf, to help you plan your weekend.

### Refreshments:

Throughout the weekend, refreshments will be available to purchase from Costa on the ground floor and the catering areas based in the Gallery behind the Network Zone upstairs. See programme overleaf for details.

### Network Zone:

The Concourse and the Gallery are the place to find the BUGB Specialist Teams and BMS stands along with representatives of some other organisations. Come along and gather ideas and resources for your local church.

### Prayer Space:

Everyone is invited to engage in prayer in **Newport 2** during the weekend. A big thank you to NWBA and Fresh Streams who have planned the Prayer Room this year - do take time during the Assembly programme to pray.

## CHILDREN and YOUTH

*Please go to the Registration Desk if you have lost your child.*

Please note, all children and young people are always the responsibility of their parents/guardians, other than when they are in their relevant programmes. All young people need to have been pre-registered to attend these programmes. The children and youth teams work under our Safeguarding policy.

### CHILDREN'S PROGRAMME

#### Wenlock 1-2

Reception - Year 6

Saturday 10:45-12:30  
15:10-17:30  
19:00-21:00 (y 3-6)

Children will need to be signed in and out of Wenlock at the beginning and end of each session. Please collect your children promptly after their sessions.

### YOUTH PROGRAMME

#### Wenlock 3-4

Year 7 - Year 13

Saturday 10:45-12:30  
15:10-17:30  
19:00-21:00

Youth aged 11-15 (and any without a permission slip) will need to be signed in and out of Wenlock at the beginning and end of each session. 16-18-year-olds may opt to attend the main programme, but must always have their permission slip with them.

There is no dedicated programme for young people on **Friday**, however the 'Everyone Everywhere' afternoon stream is offering an all-age prayer space between 2-5pm. Our **Sunday** worship service will be an All Together service.

## Welcome to Telford and to Baptist Assembly

Below is a programme for the weekend. If you have any questions at all, please do pop along to the **Information Desk** where our team will be more than happy to help.

### Friday

### PROGRAMME

12:00	Doors open	
12:00 - 21:00	Prayer Space open	Newport 2
12:30 - 19:00	Catering area open	Gallery
14:00 - 17:00	Friday afternoon streams: <i>'They devoted themselves to the apostles' teaching and fellowship'</i>	various
17:00 - 19:00	Networking Zone partly open	
19:00 - 21:00	Evening celebration: <i>'Holy Spirit Come'</i> - with address by Lynn Green	Ludlow
21:00 - 21:45	Prayer ministry available with regional associations	Ludlow

### Saturday

08:30	Doors open	
08:30 - 19:00	Networking Zone open	
08:30 - 19:00	Catering area open	Gallery
08:30 - 21:00	Prayer Space open	Newport 2
08:30 - 10:00	parkrun - meet at <b>08:40</b> in the park for briefing and welcome	Telford Park
09:30 - 10:30	<b>Bible Study: 'Wonders and Signs'</b> based on Acts 2: 1-4, led by: - Jane Day: <i>On the day of Pentecost, all those who gathered asked 'What does this mean?' - A Visio Divina Prayer Space</i> - Wale Hudson-Roberts: <i>'A violent wind came from heaven'</i> - Helen Paynter: <i>All God's promises are 'yes': Pentecost as the old fulfilled and the new begun</i>	Newport 1 Coalport 1 Atcham
11:00 - 12:30	<b>The Big Welcome and Bible Study</b> based on Acts 2: 5-15 with: Beth Allison-Glenny, Susan Myatt, Femi Onanuga and Ken Benjamin	Ludlow
12:30 - 14:00	Lunch break	
14:00 - 15:00	<b>Seminars: 'Equipping'</b> See opposite for details of our seminar programme	Various
15:15 - 16:15	<b>BUGB Meeting of the Assembly</b> With the induction of Steve Finamore as our new President and the Meeting of Assembly	Ludlow
16:30 - 17:30	Reflecting with BMS World Mission	Ludlow
17:30 - 19:00	Dinner break	
19:00 - 21:00	Evening celebration: <i>'Amazed and Astonished'</i> Including worship, In Memoriam, the recognition of Ministers, Pastors and Mission Personnel and an address by Lynn Green	Ludlow
21:00 - 22:15	<b>After Hours</b> Bar available to purchase drinks, network and renew friendships	Atcham

### Sunday

08:45	Doors open	
08:45 - 13:00	Catering area open	Gallery
08:45 - 10:00	Prayer Space open	Newport 2
09:00 - 10:30	Networking Zone open	
09:00 - 09:45	Prayer ministry	Newport 2
10:00 - 12:00	<b>Sunday service: 'All together in one place'</b> All together worship with communion and message from Carl Smethurst	Ludlow

# Telford International Centre Floor Plan

## First Floor

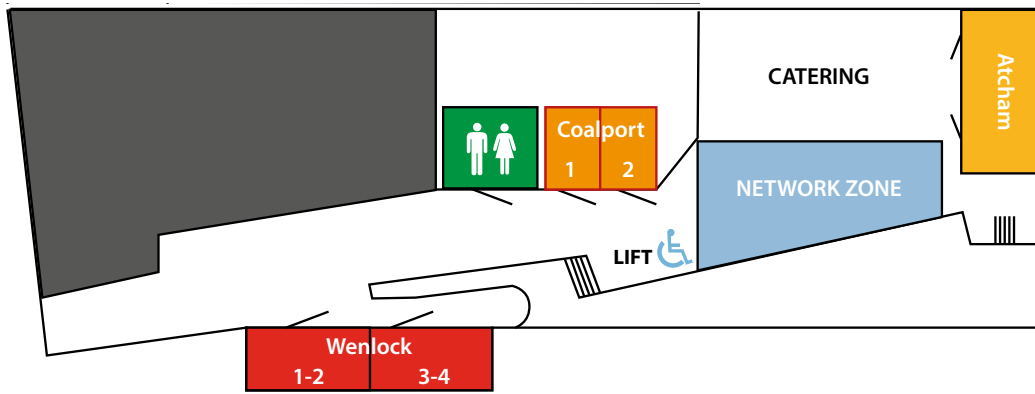

## Ground Floor

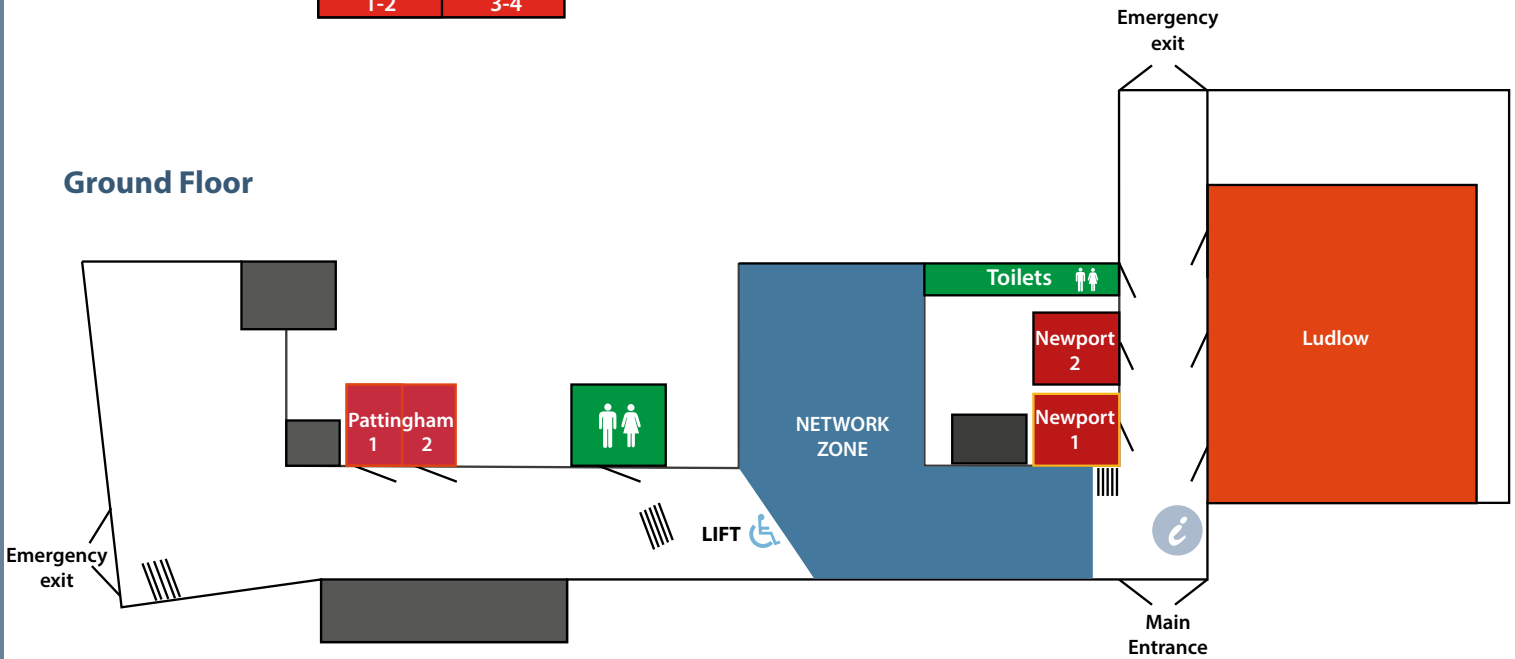

## Network Zone Participants

This year, the Network Zone is spread out over two floors and designed as a Market Street, allowing Delegates to view the work of charities, organisations and companies easily. It is a great opportunity for informal conversations with representatives and gives you the chance to learn more about the work that is being done internationally for Christ.

This year, we are pleased to welcome:

Participant	Floor	Participant	Floor	Participant	Floor
Anthony Collins Solicitors	1	Fullers Finer Furniture	G	Reform Magazine	G
Baptist Building CIO	1	Green Pastures	1	Retired Baptist Ministers' Housing Organisation (RBMHO)	G
Baptist Colleges	1	Hubb Digital	G	Single Friendly Church Network	G
Baptist Insurance Company	1	Interserve	1	Small Church Connexion	G
Baptist Union Environment Network	G	Joint Public Issues Team (JPIT)	G	Specialist Teams: Ministries/Support Services/Faith and Society	G
The Blackley Centre	1	LICC (London Institute for Contemporary Christianity)	G	Specialist Team: Safeguarding	1
BMS World Mission	G	Lifeworlds	G	St Andrew's Bookshop	G
The Boys' Brigade	G	The Light College	1	The Starfish Alliance	G
BRF Ministries	1	London City Mission	G	Thrive Baptist Spouses	G
Chris Duffett Art	1	New Housing Hub	1	Through the Roof	G
Church Edit and iKnow Church	G	Open Doors UK & Ireland	1	Trussell Trust	G
Easyfundraising	G	Operation Agri	G	Utility Aid	1
Faith in Later Life	G	The Prison Fellowship	1	Young Adults area	G
Fresh Streams	G				

# SATURDAY SEMINARS

## 'Equipping'

Taking place from 14:00-15:00

### On the day of Pentecost, all those who gathered asked 'What does this mean?'

Newport 1

As Baptists Together, we have committed to engaging with the findings of Project Violet - a three year collaborative research project examining the experiences and place of women in Baptist life, leadership and ministry. Now the findings have been released, we are all asking 'What does this mean?' Meet some of the co-researchers, explore the key themes and find out what the findings mean - and consider how to respond.



### Vital Signs of a whole-life disciple-making church

Ludlow

We know discipling in churches is important – vital, even. But how do we move from good intentions to best practice? Former Baptists Together President Ken Benjamin will be launching LICC's brand new resource – 'Vital Signs'. Ken will offer 20 ways to put whole-life discipleship at the heart of our churches. Together, they'll help you grow a culture that equips people to live out their faith in every part of life – not just through church activities.



### Reimagine Prophetic Ministry in Your Church - accessible, biblical, lifegiving

Atcham

Explore what an accessible, biblical and lifegiving prophetic ministry looks like in your context. Teaching from Sue and Andy Glover will help you reimagine prophetic ministry in your church; explain how prophetic ministry can be accessible, biblical and lifegiving; explore how prophetic ministry can impact your church and your local community.



### All age Bible Study on the mystery of Pentecost

Wenlock

Our Children, Young People and Families Round Table invite you to Join Vicky Baker as she explores the mystery of Pentecost in this all-age Bible study.



### Baptist Building CIO Reception

Coalport 1

Baptist Building CIO (formerly Baptist Building Fund) was established in 1824 to provide grants and later loans to Baptist churches throughout the UK and Ireland for building purposes. In that period the fund has helped around 4000 churches with loans that total £19m (around £140m in today's values). Come and celebrate the bicentenary, hear about work of the fund and give thanks for the contribution it has made to the life of Baptists in the UK.



### The General Election: LOVE, PRAY, VOTE!

Coalport 2

The General Election is coming, but the public perception of politics, and desire to engage with it, has arguably been more despairing in the 21st century than at any time in the last 100 years. Come and hear the various opportunities (it's not just hustings). JPIT are offering churches, to help inspire and mobilize Christians to engage with the election and beyond, for the sake of the common good.



### 'They were all together in one place'

Pattingham 1

#### – stories of bringing people together in chaplaincy

Hear chaplains from different contexts and roles share stories of bringing others together through their chaplaincy work as we reflect on the empowering work of the Holy Spirit in enabling the building of community.



### 'They were all together in one place'

Pattingham 2

- A theology of reparations through the lens of Pentecost' In 2007 Baptist Union Council offered an apology for the Baptist Union's role in the transatlantic slave trade. A series of commitments were made including reparations. Justice Enabler Wale Hudson Roberts and David Wise explore the missional and justice imperative behind Baptists Together making reparations using what we see and experience at Pentecost as a guide.



# FRIDAY STREAMS

*'They devoted themselves to the apostles' teaching and fellowship'*

Please select one of the following options taking place from 14:00-17:00

## **ART AND EVANGELISM:** Sharing the Good News of Jesus

Chris Duffett from The Light College and Collective says: 'I'm going to be going out sharing the good news of Jesus with those who are able to join me. We're going to be painting and creating and letting others in on what it means to be a follower of Christ. So come and join me, celebrating the outpouring of the Holy Spirit and heading into Telford to let others know the good news of Jesus.'

Sponsored by Baptist insurance

Venue: Atcham

## **ROAD TO RECONCILIATION**

**loosening bonds of collective memory**  
(a Mission Catalyst production) from  
BMS World Mission

BMS Head of Communication Matty Fearon will be leading this stream, drawing on the work of Lebanese theologian Martin Accad to workshop practical pathways to healing after splits.

Venue: Pattingham 1

## **EVERYONE EVERYWHERE:** Explore mission and evangelism

*Everyone Everywhere* is an emerging desire across our Baptist family to work together in helping ordinary people in ordinary ways to be confident to say something about Jesus – and expect their friends, colleagues and neighbours to become Christians because of that! And second, a desire to help ordinary churches in ordinary places imagine starting a new Christian community where it is needed, and in the way it is needed. Hear the stories and learn the lessons from all sorts of different 'baptist' ways of doing this through interactive discussions and a workshop style approach - hearing from disciple-making movements, micro-churches, chaplains, pioneers, evangelists, conventional churches and more about how God is at work through them... and how God could be at work through you! It is designed for ordinary Christians, ministers and leaders who also have a desire to see new people become Christians and new churches and Christian communities started. Co-hosted by Sandra Crawford and Alex Harris with close to a dozen other contributors.

Venue: Ludlow

## **YOUNG ADULTS AND WHOLE LIFE DISCIPLESHIP**

What would you do if a young adult turned up to your church or missional context? Perhaps they're already there, but how can you nurture whole-life discipleship in them? How can young adults live all of life with and for Christ and be disciple-makers in the everyday? Drawing from latest research and inspiring stories, we're looking forward to exploring these questions together with you. This will be an interactive session with group discussions and Q&A. *With Isabella Senior and guests Matt Jolley and Ken Benjamin from LICC*

Venue: Pattingham 2

## **DESIGNATED PERSON FOR SAFEGUARDING WORKSHOP**

*with the national Safeguarding Team*

Venue: Coalport 1

## Experts in church and home insurance

### Does your home insurance support the Baptist family?

Baptist Insurance has been protecting Baptist Churches since 1905 and has given over £2million in grants to the Baptist family.

To find out more, call **0345 070 2223**, quoting **BPA24** or visit **[www.baptist-insurance.co.uk/home-insurance](http://www.baptist-insurance.co.uk/home-insurance)**

 **BaptistInsurance**  
Experts in church and home insurance





## General Information

### FIRST AID

First aid for the event is provided by Telford International Centre (TIC). If you require assistance, please make yourself known to a TIC Steward (wearing red) or one of the team on the Registration Desk by the entrance.

### BUGB SESSION

Voting Delegates have not been issued with voting cards this year but will be asked to vote with a show of hands. Those eligible to vote include Ministers and appointed church delegates.

### ACCESSIBILITY

#### *People with limited mobility*

Telford International Centre is fully accessible, with a lift available to the first floor. If you are a wheelchair user, please ask the Stewards for directions to designated seating locations.

#### *Deaf and the hard of hearing*

Hearing dogs are welcome - if you wish to take your dog with you, please ask the Stewards for directions to suitable seats on the aisle. British Sign Language interpreters will be present at all plenary sessions. Telford International Centre has a hearing loop in Ludlow.

If you require any help throughout the day, please speak to one of the team at the Registration Desk.

#### *Visually impaired*

Guide dogs are welcome - if you wish to take your dog with you, please ask the Stewards for directions to suitable seats on the aisle. There is a limited number of extra-large print versions of the worship material which, if required, can be obtained from the Stewards or the Registration Desk.

#### *Neurodiverse*

If you are feeling overwhelmed at any point and would like to take some time in a quiet room, Pattingham 2 on the ground floor is available except during the Saturday afternoon seminar session from 14:00-15:00. Please be courteous of others using this room.

### WORSHIP MATERIAL

Worship material will be projected onto large screens. A small number of large print words will be available from Stewards or the Registration Desk for those with limited vision. If you have difficulty in seeing the screen we would also suggest that you sit to one side and front of the Auditorium.

### PHOTOGRAPHY POLICY

In line with our safeguarding policy for the event, we ask you to adhere to the No Photography policy at Baptist Assembly. There are official Assembly photographers who will take photos to be used in internal or promotional material for future Baptists Together/BMS events. If you do not wish your photo to be taken, please make the photographers aware.

### BUGB SPECIALIST TEAMS and BMS STANDS

Please do come and visit the BMS and Specialist Teams stands in the Network Zone. You will be able to sign up for the latest resources from BMS and meet members of the Baptists Together Specialist Teams who will be happy to talk to you about issues such as safeguarding, finance, HR and ministry.

### OFFERING

We invite you to help share the gospel all over the world with a financial donation. Your gifts today will go to support both mission projects in the UK through Home Mission, and the BMS Safe Haven appeal supporting refugees – either way, you'll be helping make Jesus' name truly known in the world. Please scan the QR codes or visit the websites to give what you can today:



[baptist.org.uk/homemissiondonation](https://baptist.org.uk/homemissiondonation)



[bmswm.org/safehavenba24](https://bmswm.org/safehavenba24)

If you have any questions during the day, please do ask a Steward or one of the team at the Information Desk by the entrance, who will be happy to help.